

4V、3V200 Series Solenoid Valve,4A、3A 200 Series Pneumatic Control Valve



Ordering Code

4V 2 10 08 AC220V

| | | | | | | |
|---|----------------------------------|--|--|---|--|---|
| Specification Code 4V:Two(Three)-position Five-way Solenoid Valve 4A:Two(Three)-position Five-way pneumatic control valve 3V:Two-position Three-way Solenoid Valve 3A:Two-position Three-way Pneumatic Control Valve | Series Code 200 Series | Coil and Places 10:Single-head double-position 20:Double-head double-position 30C:Double-head Three-position Close Type 30E:Double-head Three-position Exhaust Type 30P:Double-head Three-position Pressure Type | Port Size 06:G1/8" 08:G1/4" | Port connection and Initial State NC:Two-position Three-way Normal Close Type NO:Two-position Three-way Normal Open Type | Standard Voltage DC12V DC24V AC24V 50Hz/60Hz AC110V 50Hz/60Hz AC220V 50Hz/60Hz AC380V 50Hz/60Hz | Wiring Form Blank:Standard Connector LD:Brown With Lighting Connector LD1:White With Lighting Connector W:Lead Wire Type |
|---|----------------------------------|--|--|---|--|---|

Specification

| Model | 4V210-06 | 4V220-06 | 4V230C-06 | 4V230E-06 | 4V230P-06 | 4V210-08 | 4V220-08 | 4V230C-08 | 4V230E-08 | 4V230P-08 |
|--------------------------|-----------------------------|----------|-----------------------------|-----------|-----------|-----------------------------|----------|-----------------------------|-----------|-----------|
| Position and Way NO. | Two-position Five-way | | Three-position Five-way | | | Two-position Five-way | | Three-position Five-way | | |
| Effective Sectional Area | 14mm ² (CV=0.78) | | 12mm ² (CV=0.67) | | | 16mm ² (CV=0.89) | | 12mm ² (CV=0.67) | | |

| Model | 3V210-06 | 3V220-06 | 3A210-06 | 3A220-06 | 3V210-08 | 3V220-08 | 3A210-08 | 3A220-08 |
|------------------------|------------------------------------|----------|----------|----------|---|----------|----------|----------|
| Position and Way NO. | Two-position Three-way | | | | Two-position Three-way | | | |
| Effective Section Area | 14mm ² (CV=0.78) | | | | 16mm ² (CV=0.89) | | | |
| Joint Pipe Bore | Air Inlet=Air Outlet=Exhaust=G1/8" | | | | Air Inlet=Air Outlet 1/4" Exhaust=G1/1/8" | | | |

| | |
|-------------------------------|-----------------------------|
| Working Medium | 40 Micron Filtered Air |
| Motion Pattern | Inner Guide Type |
| Working-pressure | 0.15~0.8 M Pa |
| Max. Pressure Resistance | 1.2MPa |
| Operating Temperature | 5~50 C |
| Voltage Range | ±10% |
| Power Consumption | AC: 2.5VA DC: 2.5W |
| Insulation & Protection Class | F Class. IP65 |
| Wiring Form | Lead Wire or Connector type |
| Highest Action Frequency | 5 Cycle / Sec |
| Shortest Excitation Time | 0.05 Second |

4V、3V200 Series Solenoid Valve,4A、3A200 Series Pneumatic Control Valve

Overall Dimensions

4V210-06

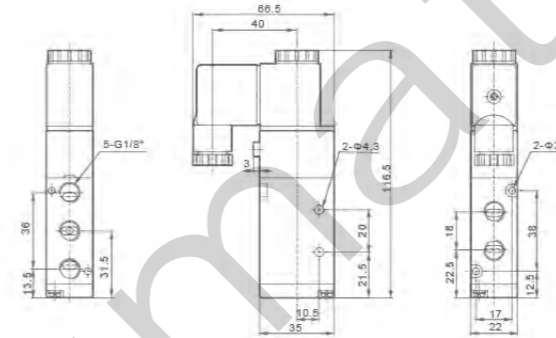

4V210-08

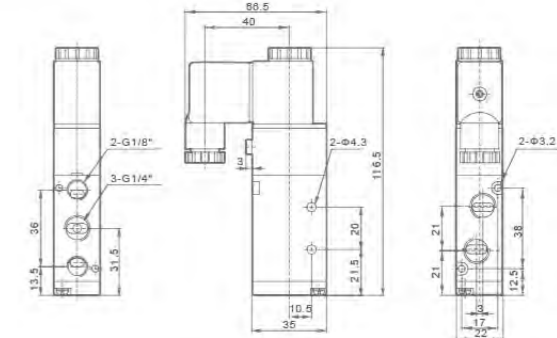

4V220-06

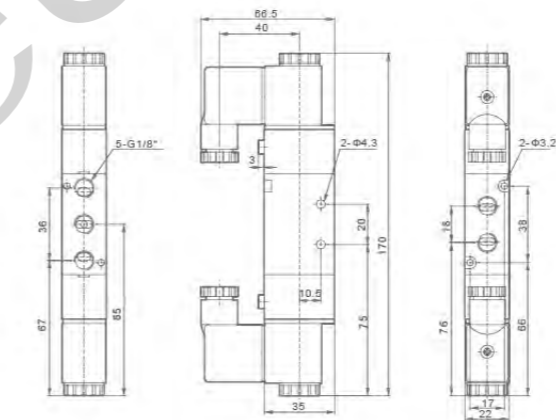
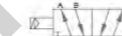

4V220-08

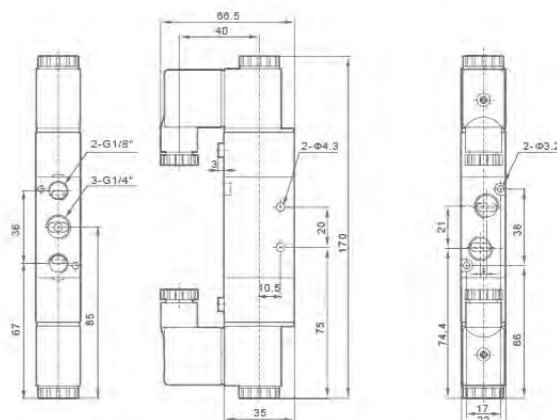

4V230-06

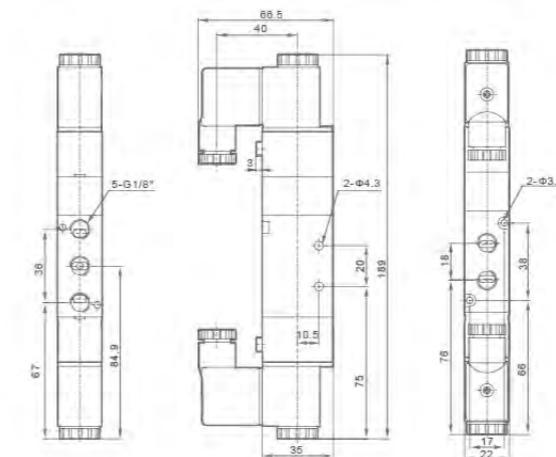
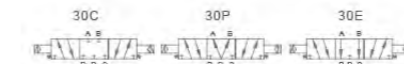

4V230-08

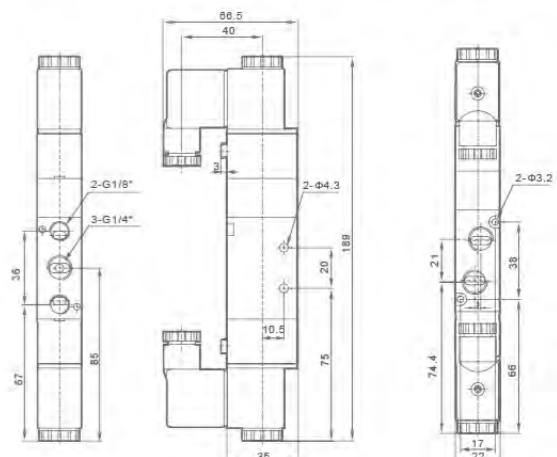
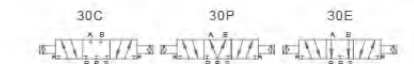

4V、3V200 Series Solenoid Valve, 4A、3A 200 Series Pneumatic Control Valve

Overall Dimensions

4A210-06

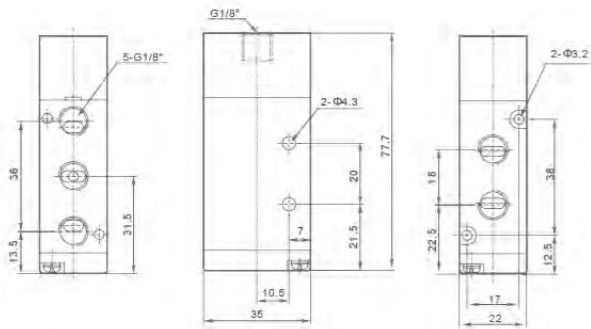

4A210-08

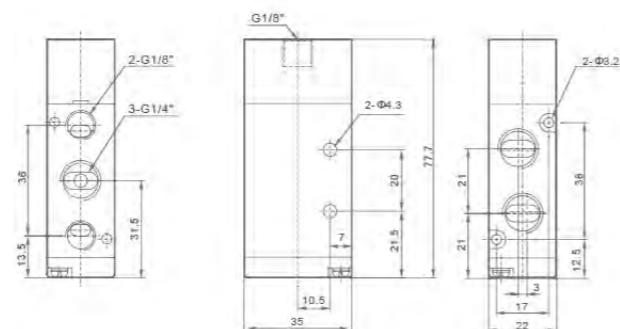

4A220-06

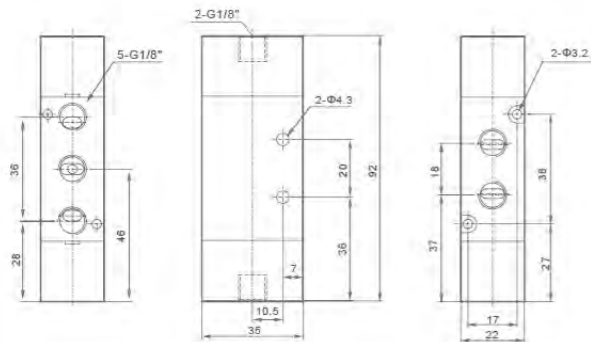
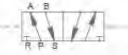

4A220-08

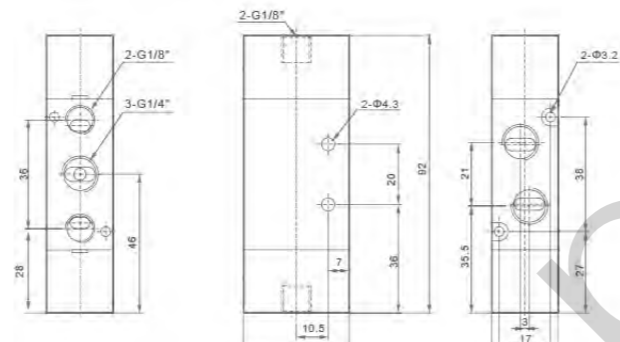
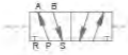

4A230-06

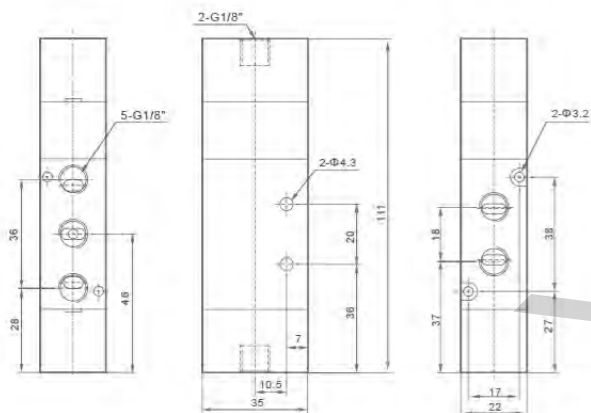
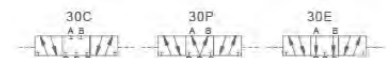

4A230-08

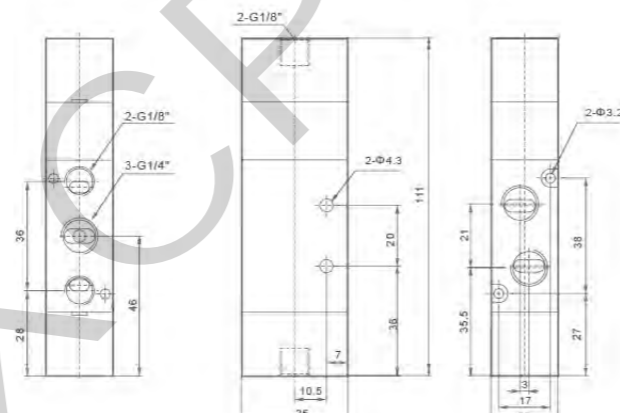

4V、3V200 Series Solenoid Valve, 4A、3A 200 Series Pneumatic Control Valve

Overall Dimensions

3V210-06

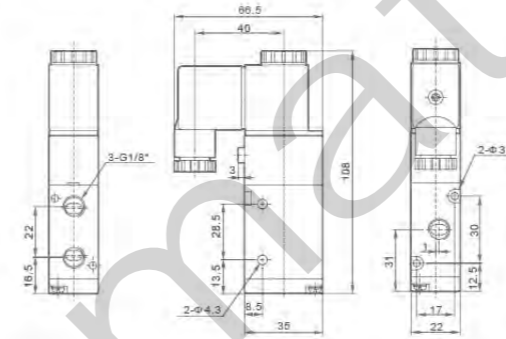
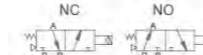

3V210-08

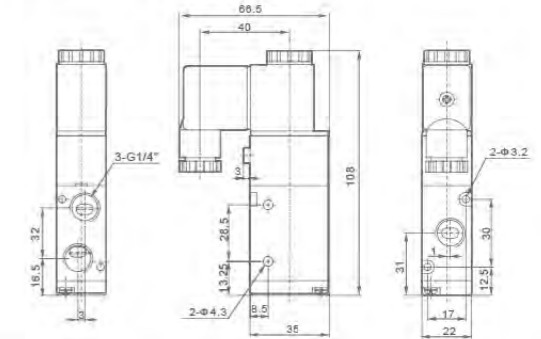
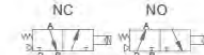

3V220-06

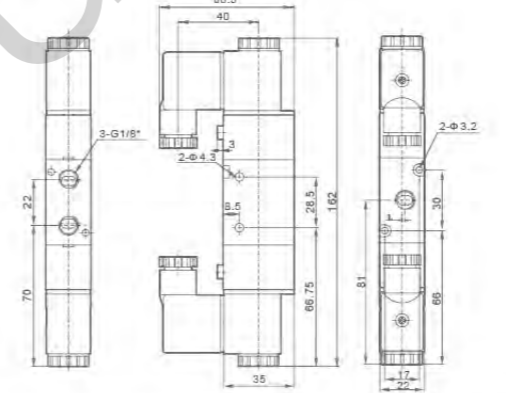

3V220-08

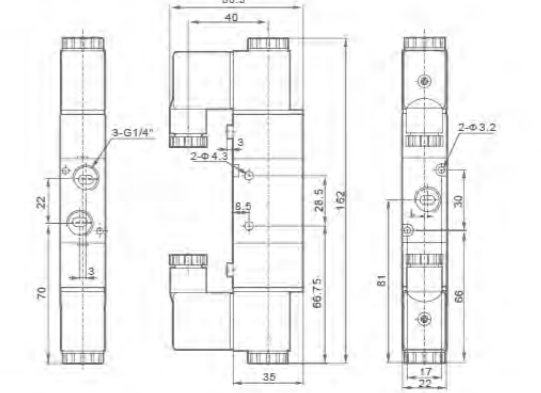

3A210-06

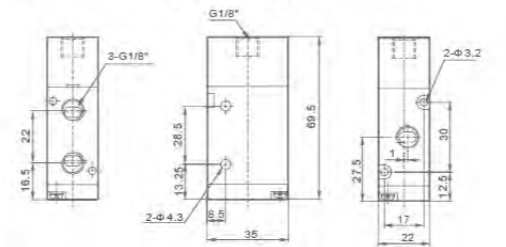
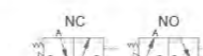

3A210-08

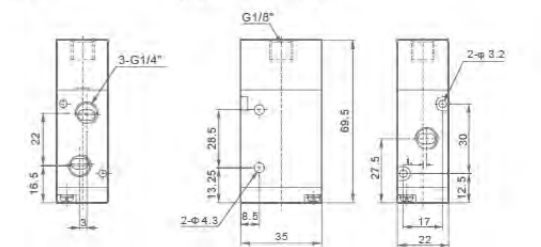
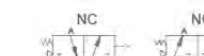

3A220-06

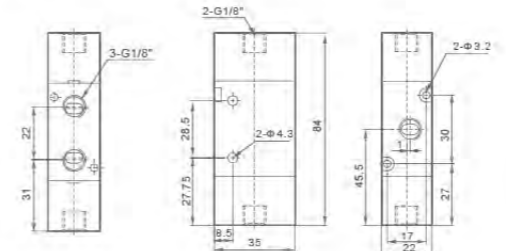
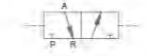

3A220-08

